

STI UNIVERSAL BUTTON



UB-1



UB-1/LTUL



PRODUCT OVERVIEW

This momentary button helps eliminate having to stock dozens of push buttons, and wasting precious time and money tracking down just the right button for a customer. It offers many options to provide just what a customer wants in one convenient package. Button is ready to be assembled out of box and is easily installed within minutes on site.

Universal Button offers over 300 different combinations for the price of a standard one configuration button. The faceplate is constructed of cast aluminum metal, allowing it to take tough knocks in stride, and is slightly oversized to cover old plate installation marks. Button package includes: faceplate, three illuminated push buttons, five changeable button messages and ten changeable illuminated activation messages.

HOW IT WORKS

The installer simply has to choose which lens cover, button insert and interchangeable message plate works best for the customers need, and easily snap them in place. This allows the button to be mounted in a matter of minutes instead of waiting weeks for a specific button to be ordered and delivered.

KEY FEATURES

General Information

- Offers over 300 different combinations.
- Momentary button offers many options to provide just what a customer wants in one convenient package.
- 100,000 operations.
- One year guarantee on electro mechanical and electronic components.

Construction

- Faceplate constructed of cast aluminum.
- UL Listed to U.S. and Canadian safety standards.
- LTUL models Listed for access control UL294.

Installation

- Temperature: -40° to 185° F (-40° to 85°C).
- Mounts to standard electrical handi box.
- Single gang plate slightly oversized to cover old plate installation marks.

Electronics

- Illuminated 12/24 volt LED button and illuminated message light kit.
- Two sets of independent Form "C" contacts.
- Contacts rated 10A @ 125/250 VAC, 6A @ 30 VDC.

Options

- Five inserts for the button included – EXIT, PUSH, PUSH TO EXIT, handicap symbol and blank.
- Three different lens covers included – red, green and blue.
- Ten color coated message inserts in green, blue, yellow and white.
- Plate messages inscribed with EXIT, EMERGENCY and translucent blanks (allowing for custom labels).

STI Universal Button

Dimensions and Technical Information

MODELS AVAILABLE

UB-1	Universal Button
UB-2	2" Universal Button
UB-1-LTUL*	Universal Button with UL Latching Timer
UB-2-LTUL*	2" Universal Button with UL Latching Timer

Accessories

LT-1	Latching/Timer Module
LT-1UL	UL Latching/Timer Module
UB-1LENS	1" Lens Kit (red, green, blue)
UB-2LENS	2" Lens Kit (red, green, blue)
UB-1CL-★	Custom Label applied to blank, changeable message plates (blue, green, white or yellow)
KIT-UB-1C	Contact Block
KIT-71100A-★★	Color Match Back Box Kit (red, blue, green, white or yellow)
KIT-E10147	24 Volt LED, White (standard)
STI-6518	Bopper Stopper® Protective Cover

*See LT-1 for complete latching/timer information

★ B = blue, G = green, W = white, Y = yellow

★★ R = red, B = blue, G = green, W = white, Y = yellow

APPROVALS & WARRANTY

TESTING

It has been tested and approved or listed by:

- UL/cUL File S7255
- UL 2017
- UL 294 (models ending with LTUL)
- CSA C22.2 No. 205
- ADA for operation

WARRANTY

One year guarantee on electro mechanical and electronic components.

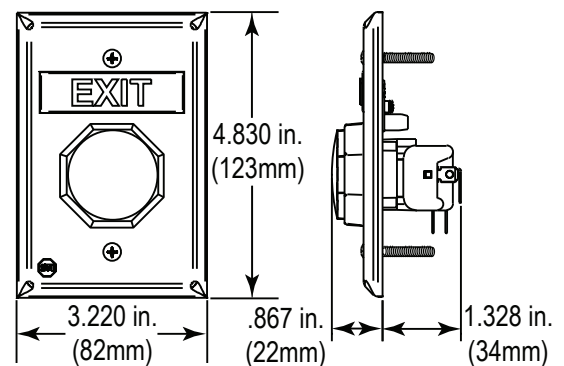
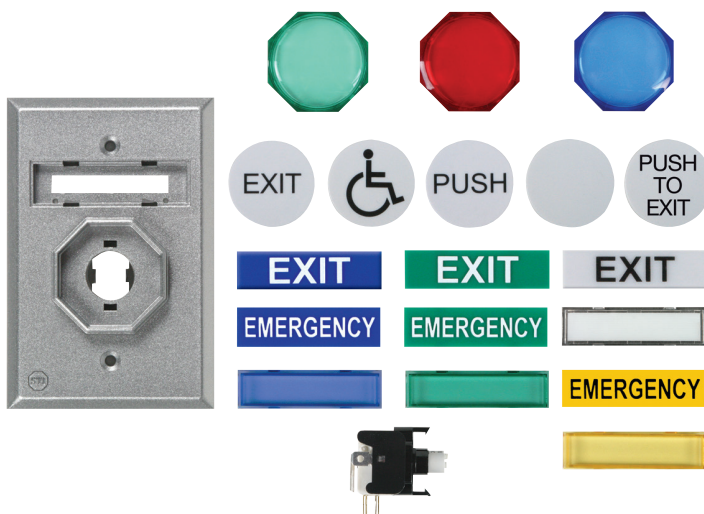

**Safety Technology
International**

2306 Airport Road info@sti-usa.com
Waterford, MI www.sti-global.com
48327, USA Tel: 248-673-9898

Taylor House info@sti-emea.com
34 Sherwood Rd., Bromsgrove, www.sti-global.com
Worcs., B60 3DR, England Tel: +44 (0) 1527 520 999

Unit 7A Lockheed Avenue
Airport Business Park
Waterford X91 HWF2 Ireland