

# 8MP Network LumiLuxSmart Bullet Camera (Vari-Focal)

N3B-8LAV



## Key Features

- 8MP Bullet Housing
- 2.7 mm to 13.5 mm Motorized Vari-Focal Lens
- LumiLuxSmart — IR and White-Light LEDs
- Video Content Analytics: Line Crossing, Intrusion
- iMD

## Certifications and Compliance

- NDAA Compliant
- FCC
- IC
- ONVIF

## Learn More



Learn more about this product's key technologies.

View all compatible accessories for this product.

## Overview

The **N3B-8LAV** is part of Luminys's N3 Starter series. N3 series devices are designed with a curated selection of technologies and features to provide high-quality security without unnecessary or complicated add-ons.

This camera is equipped with LumiLuxSmart technology to provide unparalleled customization and flexibility to meet the needs of today's security market. LumiLuxSmart cameras allow users to switch between three low-light functionalities: covert IR- only mode, nighttime white-light LED lighting, and motion-activated IR and LED dual-illumination. The brightness and intensity of the white-light LEDs can be remotely adjusted, preventing unnecessary light pollution. With its smart design, this camera is ideal for small to mid-sized applications.

## Key Technologies

**LumiLuxSmart** technology LumiLuxSmart technology allows cameras to capture clear, full-color video day or night. When motion is detected, LumiLuxSmart cameras switch from IR LEDs to white-light LEDs to illuminate a scene, then switch back to IR mode once motion has ceased to prevent light pollution and energy inefficiency.

**Intelligent Motion Detection (iMD)** technology accurately detects and filters humans and vehicle in a monitoring area. Using an advanced algorithm, iMD can accurately detect humans and vehicles while reducing false alarms caused by other objects, animals, or lighting. Users can be alerted to iMD events for timely security. iMD events can be saved for future reference and easily searched for at a later time for forensic analysis and to assist in investigations.

**Video Content Analytics (VCA)** is the umbrella for line crossing and intrusion analytics. Line crossing identifies when a person or object crosses a defined line. Intrusion detects when a person or object breaches the boundaries of a defined area or enters a restricted area. VCA is available on most Luminys network cameras.

# Specifications

## Camera

Luminys Series	N3 Series (Starter)
Image Sensor	1/2.7-in. 8MP Progressive CMOS
Maximum Resolution	3840 x 2160
Minimum Illumination	<b>Color:</b> 0.007 Lux at F1.6 <b>Black/White:</b> 0.0007 Lux at F1.6 0 Lux With IR Light On
Number of Illuminators	Two (2) White-Light LEDs, Two (2) IR LEDs, Supports LumiLuxSmart
Illuminator Control	Automatic, Manual, Zoom Priority
Maximum Illumination Distance	<b>IR:</b> Up to 61.0 m (200.0 ft) <b>White Light:</b> Up to 61.0 m (200.0 ft)
Electronic Shutter Speed	Automatic, Manual 1/3 s to 1/100,000 s
Installation Angle	<b>Pan/Rotation:</b> 0° to 360° <b>Tilt:</b> 0° to 60°
S/N Ratio	> 56 dB

## Lens

Iris Type	Fixed
Lens Type	Motorized Vari-Focal
Focal Length	2.7 mm to 13.5 mm
Maximum Aperature	F1.5
Field of View	<b>Horizontal:</b> 114° to 32° <b>Vertical:</b> 58° to 17° <b>Diagonal:</b> 138° to 36°
Close Focus Range`	0.8 m (2.6 ft)
DORI Distance	<b>Detect:</b> 85.0 m to 279.5 m (278.9 ft to 917.0 ft) <b>Observe:</b> 33.9 m to 111.8 m (111.22 ft to 366.80 ft) <b>Recognize:</b> 16.9 m to 55.8 m (55.45 ft to 183.07 ft) <b>Identify:</b> 8.3 m to 27.8 m (27.23 ft to 91.21 ft)

## Video

Compression	Smart Encoding H.265+, H.265, Smart Encoding H.264+, H.264, MJPEG (Sub Stream Only)
Standard Codec	Supported
Stream Capability	Two (2)
Resolution	8MP (3840 x 2160), 6MP (3072 x 2048), 5MP (3072 x 1728), 5MP (2880 x 1620), 4MP (2688 x 1520), 3MP (2048 x 1536), 3MP (2304 x 1296), 1080P (1920 x 1080), 1.3MP (1280 x 960), 720P (1280 x 720), D1 (704 x 480), VGA (640 x 480), CIF (352 x 240)
Maximum Frame Rate	<b>Main Stream:</b> 3840 x 2160 at 20 fps <b>Sub Stream 1:</b> D1 at 30 fps
Video Bit Rate	<b>H.264:</b> 3 kbps to 8,192 kbps <b>H.265:</b> 3 kbps to 8,192 kbps
Bit Rate Control	CBR/VBR
Day/Night	Automatic (ICR), Color, Black and White
Light Balancing	Wide Dynamic Range (120 dB)
Noise Reduction	3D NR

## Video

Image Angle	0°/90°/180°/270° (Only 90°/270° Available for 2688 x 1520 Resolution or Lower)
Mirror Rotation	Supported
Region of Interest	Four (4) Zones
Privacy Masking	Four (4) Zones

## Analytics

Video Content Analytics	Line Crossing, Intrusion
Intelligent Motion Detection	Supported with Alarms for Vehicles and Humans

## Audio

Compression	G.711a, G.711Mu, PCM
Interface	<b>Input:</b> Built-in Microphone and One (1) RCA Input <b>Output:</b> One (1) RCA Output

## Alarm

Event	Line Crossing, Intrusion, Motion Detection, iMD, Audio Detection, Video Tampering, Disk Full, Disk Error, Voltage Detection, Security Exception
Interface	<b>Input:</b> One Port (Max. 5 VDC, 5 mA) <b>Output:</b> One (1) Port (Max. 12 VDC, 300 mA)

## Network

Protocol	RJ-45 (10/100 Base-T)
Protocol	IPv4, IPv6, DNS, TCP, UDP, DHCP, HTTP, HTTPS, 802.1X, RTSP, DDNS, P2P, SMTP, RTMP, UPnP, Auto Registration, ICMP, IGMP, FTP, SFTP, RTP, RTCP, ARP, NTP, Multicast, NFS
Interoperability	ONVIF (Profile S/G/T), CGI
Browser	Chrome, Firefox, Edge
Client	LumiViewer, LumiViewer Mobile App
Storage	FTP, NAS, SFTP, Micro SD Card (Max. 256 GB)

## Electrical

Power Supply	12 VDC, PoE (802.3af)
Power Consumption	<b>12 VDC</b> <ul style="list-style-type: none"><li>• <b>Maximum:</b> 6.9 W</li><li>• <b>Normal:</b> 2.6 W</li></ul> <b>PoE</b> <ul style="list-style-type: none"><li>• <b>Maximum:</b> 8.3 W</li><li>• <b>Normal:</b> 3.3 W</li></ul>

## Construction

Net Weight	1.1 kg (2.4 lb)
Gross Weight	1.4 kg (3.0 lb)
Operating Temperature	-40 to 60 °C (-40 to 140 °F) < 95% RH (Non-Condensing)
Storage Temperature	-40 to 60 °C (-40 to 140 °F)
Protection Ratings	IP67, IK10
Product Dimensions (L x W x H)	290.6 mm x 98.6 mm x 91.2 mm (11.4 in. x 3.9 in. x 3.6 in.)



Packaging Dimensions (L x W x H)	369.0 mm × 148.0 mm × 139.0 mm (14.5 in. × 5.8 in. × 5.5 in.)
Material	Metal + Plastic
<b>Certifications and Compliance</b>	
Certifications	FCC, IC
Compliance	NDAA

## Dimensional Drawing

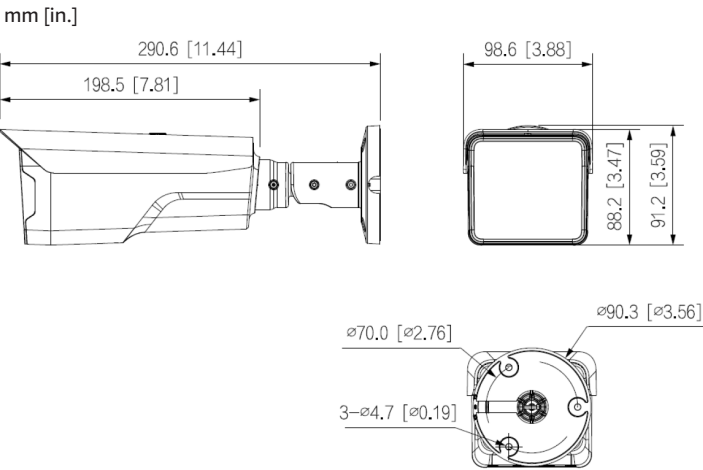

## Optional Accessories

Below are the optional accessories for this product. All SKUs listed must be purchased to complete an accessory combination. For more information and to see mounting combinations, please view our accessory selector at <https://www.luminyscorp.com/products/accessories>.

Accessory Combination	SKU(s)	Description
Junction Box*	N5B-J01	Junction Box
	N5B-A01	Water Joint for N5B Junction Box
Pole Mount*	N5B-J01	Junction Box
	N5B-A01	Water Joint for N5B Junction Box
	N3/N5-P01	Pole Mount Bracket
Corner Mount*	N5B-J01	Junction Box
	N5B-A01	Water Joint for N5B Junction Box
	C01	Corner Mount Bracket

\*All SKUs must be purchased to complete the mounting combination. Failure to purchase all SKUs listed will result in an incomplete mount.